

# PRODUCT INFORMATION

## How to extend the life of your Borum Clutch Jack

### 5 Top Tips

### to extend the life of your TQB BRANDS BORUM BCJ130 Clutch Jack

- 1** Regularly lubricate the tilt adjust rods, pivot points and castors.

Lubrication of all pivots, pins, adjusters, and castor wheels ensures smooth operation during lifting and adjustment procedures while removing clutch assemblies.

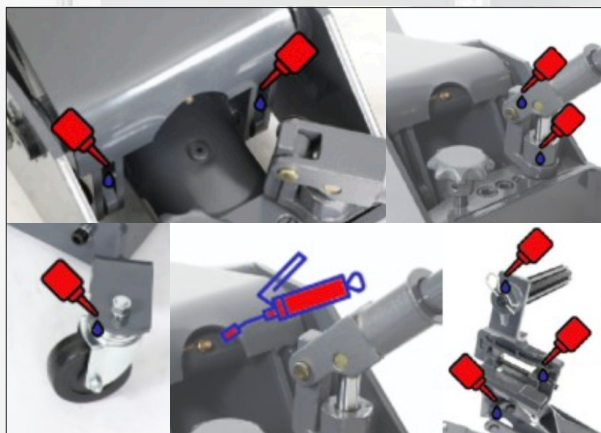

- 2** Always store in the fully lowered position.

Storage in the lowered position ensures the lift ram assembly is sealed from exposure to weather fluctuations and keeps the hydraulic ram seals in a relaxed condition ready to work when required.



TQB Brands Borum Clutch Jacks use \* ISO32 hydraulic oil in their hydraulic ram and pump power packs to ensure compatibility with the seals used in their assembly.

- 3** Never use the clutch jack for supporting loads.

To ensure long life of the hydraulic lift ram seals, a load must not be supported above the fully lowered position for extended periods such as overnight. Once a clutch assembly is removed from a vehicle the loaded clutch assembly should be fully lowered where the internal mechanical travel stops can support the load.



- 4** Levelling the load on the spline.

Correct levelling of the load is a critical factor where alignment of the flywheel/pressure plate is required. Keep the levelling adjustor lubricated to ensure easy adjustments under load.



- 5** Read the users Manual thoroughly and keep a copy easily accessible.

The users manuals are important to the initial set up and ongoing maintenance and come with each clutch jack, they are also downloadable from our webpage at [www.tqbbrands.com.au](http://www.tqbbrands.com.au)